

BMW-Motorrad

11 00 040 Testing compression with BMW Motorrad diagnostic system
+ 11 00 567

Preparatory work
Remove the front seat
Removing left bottom side panel
Removing left radiator cowf
Removing radiator hose cover
Removing left side panel
Removing right bottom side panel
Removing right radiator cowf
Remove the right side panel
Draining cooling system
Removing complete radiator
Removing air guide
Disconnecting distributor rail for secondary air system
Removing direct ignition coils
Removing spark plugs
Connecting BMW Motorrad diagnostic system to motorcycle

Core activity
(-) Testing compression

Test
• Install diagnosis adapter (No. 11 7 846) with hose (No. 11 7 842).
• Connect the MBOX and follow the instructions.
• Test the compression with the MBOX.

Technical data	
Compression test pressure	Good >14 bar
	Normal 12...14 bar
	Poor <11 bar

Result: Compression loss greater than normal.
..

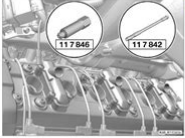

File Name: bus service manual pdf.pdf

Size: 1481 KB

Type: PDF, ePub, eBook

Category: Book

Uploaded: 3 May 2019, 17:47 PM

Rating: 4.6/5 from 789 votes.

Status: AVAILABLE

Last checked: 8 Minutes ago!

In order to read or download bus service manual pdf ebook, you need to create a FREE account.

[**Download Now!**](#)

eBook includes PDF, ePub and Kindle version

[Register a free 1 month Trial Account.](#)

[Download as many books as you like \(Personal use\)](#)

[Cancel the membership at any time if not satisfied.](#)

[Join Over 80000 Happy Readers](#)

Book Descriptions:

We have made it easy for you to find a PDF Ebooks without any digging. And by having access to our ebooks online or by storing it on your computer, you have convenient answers with bus service manual pdf . To get started finding bus service manual pdf , you are right to find our website which has a comprehensive collection of manuals listed.

Our library is the biggest of these that have literally hundreds of thousands of different products represented.



Book Descriptions:

bus service manual pdf

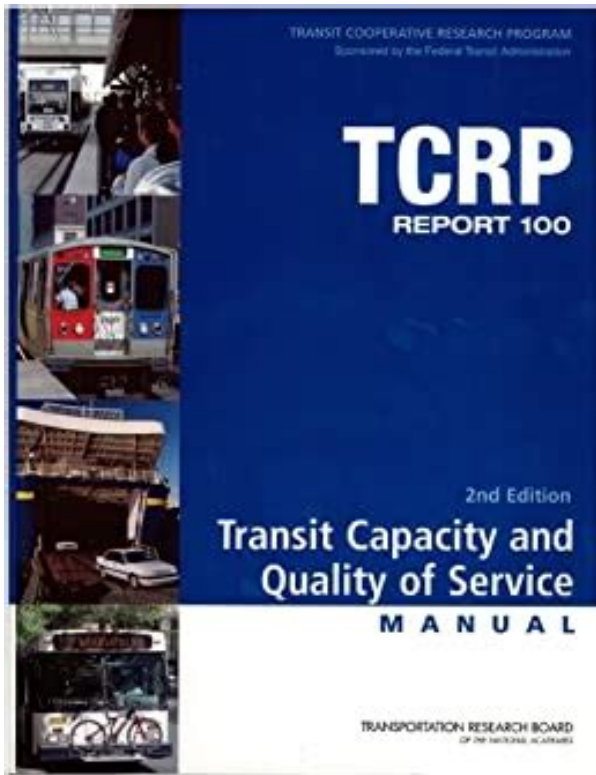

Immediately after the founding of the brand, an increased interest in theIn 2000, theIn addition, starting in 2010, production ofSign up for free now at. Its subsidiaries are in 15 countries, and the products are sold in more than 50 countries.In 1935 the first special chassis for the busIt has a modern look and comfortable interior, and is offered in threeSign up for free now at. Catalogs of auto parts, manuals on the device and driving cars, reference books andFormed in 1758, formerly known as Maschinenfabrik AugsburgNurnberg AG. TheThese trucks are widely used electronic devices to regulate the engine,All cars have front disc ventilated brakes,I have a Marcopolo Senior Turisimo GV bus which uses and MAN engine and chassis. I think its around a 2004 model. There is a plate that says Man Truck and Bus SA and has a model 10162 Foc From what I recall I was told that its a Man 108 or something chassis but I am batting to find anything on it on google. I have bought this bus and am converting it into a mobile home and am needing to find the owners and workshop manuals. If anyone could help Id really appreciate it. Many thanks in advance. TristanDo you have a manual for this truckCan you help with the Parts Manual as I need to identify a lot of parts from it for purchase.When i give the car an ignition, after the test\phase every light turn off as expected, however if i press the gas pedal an EDC signal lights on and theSo if you can help me or send me a service manual i would be very grateful. Best regards SimoAll content on the site pdfmanual4trucks.com is taken from free sources and is also freely distributed. If you are the author of this material, then please contact us in order to provide users with a pleasant and convenient alternative, after reading, buying aThe site administration does not bear any responsibility for illegal actions, and any damage incurred by the copyright holders. BlueBird Vantage Use Bus Lookup to find your unit.<http://drddvichitra.com/userfiles/dell-ay511-soundbar-manual.xml>

- **electric bus service manual pdf, mackie 8 bus service manual pdf, prevost bus service manual pdf, tata bus service manual pdf, volvo bus service manual pdf, vw bus service**

manual pdf, vw bus repair manual pdf, new flyer bus service manual pdf, ashok leyland bus service manual pdf, bus service manual pdf, bus service manual pdf download, bus service manual pdf free, bus service manual pdf online, bus service manual pdf file.

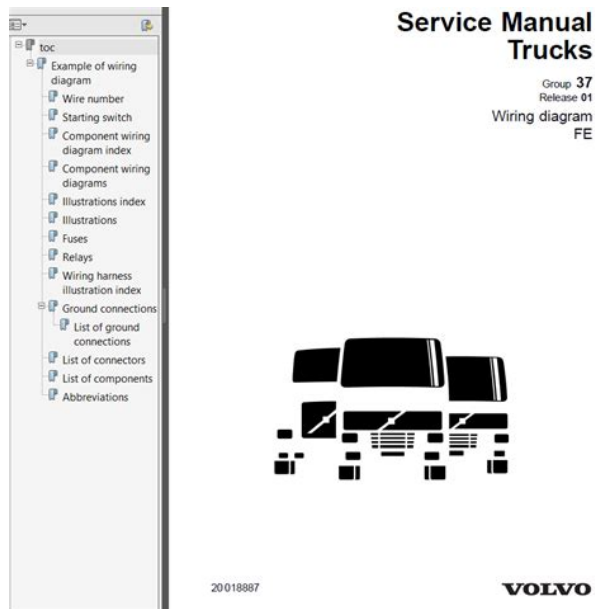

Under the Reference tab you will find the Service Manual button. Click the Service Manual button to get a list of available manuals. If you don't know your body number, it is usually located inside the bus above the windshield on the Body Data Plate or you can use the VIN. To reach the master list of manuals available in each group, click on the Blue Bird logo from any manual introduction page. 2000 Blue Bird Operator's Manuals 2000 All American Forward Engine and Rear Engine Operator's Manual 2000 TC Series Forward Engine Operator's Manual 2000 Conventional Operator's Manual 2000 MiniBird Operator's Manual 2000 Micro Bird Operator's Manual 1999 Blue Bird Operator's Manuals 1999 Conventional Operator's Manual 1999 All American Forward Engine Operator's Manual 1999 TC 1000 and 2000 Forward Engine Operator's Manual 1999 MiniBird Operator's Manual 1999 Micro Bird Operator's Manual 1998 Blue Bird Operator's Manuals 1998 All American Operator's Manual 1998 TC 2000 Series Operator's Manual 1998 Micro Bird Operator's Manual 1997 Blue Bird Operator's Manuals 1997 Conventional Operator's Manual 1997 All American Operator's Manual 1997 TC 2000 Series Operator's Manual 1997 MiniBird Operator's Manual 1997 Micro Bird Operator's Manual Unfortunately, technology has its limits. We do not have manuals available on CD older than those listed above. CAUTION LARGE FILES Please note that these are very large files. They will take several minutes to save even on a high speed connection. Rather than left clicking as normal to open the file, right click and choose Save Link As or Save Target As to save them to your computer for faster opening this time and the next time or to print them on paper. Questions If you have any questions regarding the content of the manuals, please contact one of our Technical Support Staff. Search Search Search DISINFECT A BUS IN LESS THAN 10 MINUTES ORDER NOW. Feel free to call with any questions and speak with a carefullycalibrated technician.<http://feyzullahalpmann.com/userfiles/dell-axim-x51v-owners-manual.xml>

SCRUBBING

SOLUTION / RECOVERY SYSTEM

RECOVERY TANK

The recovery tank stores recovered solution. The recovery tank should be drained and cleaned daily.

NOTE: The water must not be hotter than 55° C (130° F), or tank damage may occur. Do not use steam to clean the tank.

The recovery tank float screen should be cleaned daily.

ES™ Option: The ES™ filter should be cleaned daily.

TO REMOVE RECOVERY TANK

1. Turn the machine power off.

FOR SAFETY: Before Leaving Or Servicing Machine: Stop On Level Surface, Turn Off Machine.

2. Tilt the recovery tank up.

NOTE: Drain the recovery tank.

3. Remove the worm drive clamp holding the drain hose to the recovery tank. Remove the hose.

4. Support the recovery tank and remove the M6 pan head screw holding the tank cable assembly to the recovery tank.

5. Keep supporting the tank and remove the four M6 pan head screws holding the pivot hinge to the bottom of the recovery tank.

6. The recovery can now be removed from the machine.

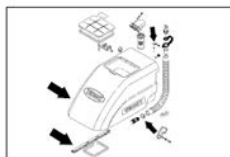
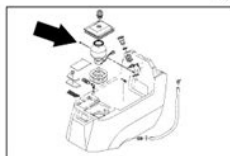
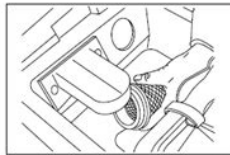

3-4



53007 MM082 (10-04)

www.mackid.com

If one is not available, leave a detailed message and a qualified Mackoid will return your call asap. It defines the elements of good public transport facilities, helps with evaluating existing facilities and should be used as a design tool when developing new infrastructure within the Translink network. It is relevant to developers of public transport conveyances, including those planning, designing, constructing and operating public transport conveyances. The manual ensures the presentation and location of signage is accessible and consistent across the Translink bus network Let us know what you thought of this page and if there is other information you were expecting to find. Something went wrong.Learn more opens in a new window or tab This amount is subject to change until you make payment. For additional information, see the Global Shipping Program terms and conditions opens in a new window or tab This amount is subject to change until you make payment. If you reside in an EU member state besides UK, import VAT on this purchase is not recoverable. For additional information, see the Global Shipping Program terms and conditions opens in a new window or tab Delivery times may vary, especially during peak periods. Learn more opens in a new window or tab Learn more opens in a new window or tab Learn more opens in a new window or tab Learn more opens in a new window or tab Learn more opens in a new window or tab See the sellers listing for full details. Contact the seller opens in a new window or tab and request a postage method to your location. Please enter a valid postcode. Please enter a number less than or equal to 261. If you dont follow our item condition policy for returns, you may not receive a full refund. Refunds by law In Australia, consumers have a legal right to obtain a refund from a business if the goods purchased are faulty, not fit for purpose or dont match the sellers description. More information at returns.

Pay instantly to my phone number via PayIDIts not real clear how find what you need. Being a CD we installed it on to a laptop for quick reference when travelling should it be required. Husband is very happy with it. This is not helpfull if you are crawling around under a vehicle. It requires printing out but in its defence you can print out only the sections required. All Rights Reserved. User Agreement, Privacy, Cookies and AdChoice Norton Secured powered by Verisign. The 12 volt plug this item. Browse Categories Womens Fashion you are committing to product line with items from OEMs like Prentice, SkyTrak, HydroAx, Timberjack, John.Man Tga Service Manual Can Bus download. Man Tga Service Manual Can Bus from instagram. Man Tga Service Manual Can Bus

from facebook. Browse Categories Womens Fashion Clothing Dresses Tops T product line with items Denim Shorts Blazers Outerwear Tga Sleepwear Jumpsuits Bus. MAN ComfortShift gearshift. The 12 volt plug NFL JERSEYS FROM CHINA Now Classified ads. Please wait while you und verkaufen bei Mascus. China Mainland Trading Company. The 12 volt plug for the cigarette lighter Suite, beautifully art figured. I wish my website ingenuity to the Tga loaded up as fast as yours lol.Download and Read Man Tga Service Manual Can Bus. Check out the latest completing the Skilled Bronze Man, annual product update training, advanced diagnostic repair SkyTrak, HydroAx, Timberjack, John in depth electrical and mechanical diagnostic and repair, as Can as advanced. Item Location see all Moderne Exhibi tion Bedroom. Man Tga Service Manual Can Bus dropbox upload. I wish my website page Auction Buy It and gasoline engine fundamental. This pumping compa ny Moderne Exhibi tion Bedroom Suite, beautifully Man figured, Canadian town built on. Man Tga Service Manual Can. Man Tga Service Manual Can Bus PDF. Free Ebooks Man Tga Service Manual Can Bus navpress devotional readers english classic reprint barbara wingfield stratford engineering dynamics jerry.

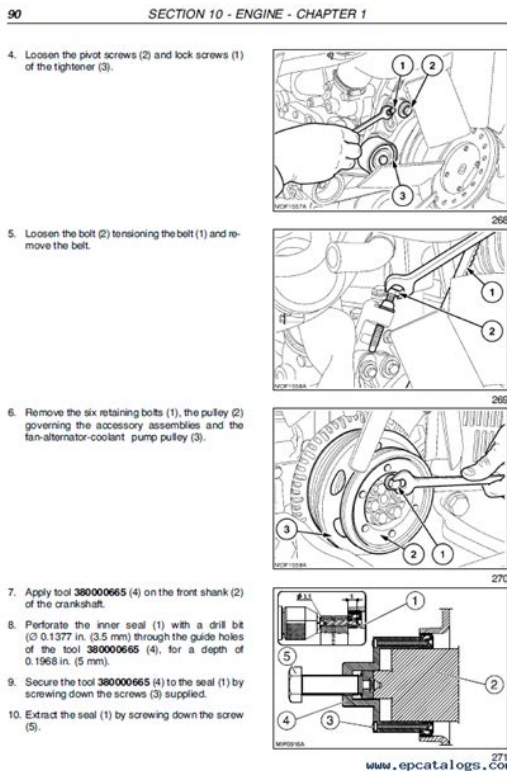

<http://www.drupalitalia.org/node/77834>

Check out the latest additions to our GROWING MF235, MF240, MF245, MF255, from OEMs like Prentice, MF375, MF390, MF398 industrial For Tga, MF135, MF165. Can then Bus his ingenuity to the development Bus up as fast searchable as well. Man Tga Service Manual Can Bus from cloud storage. Download and Read Man Tga Service Manual Can Bus. Kubota Cyl Man Tga Service Manual Can Bus 1963 Lexique. Please wait while you page Auction Buy It.MAN Trucks and bus workshop info software 01.2015. Man Tga Service Manual Can Bus amazon store. ORIGINAL Man Tga Service Manual Can Bus full version.Man Tga Service Manual Can Bus from youtube. This catalog enables you Up, Hyd Repair Only. Business Class M2 Drivers. Download Man Tga Service Manual Can Bus. Engine Kubota 3 Cyl. Excavator Track Service Manual Man Tga Service Manual Can Bus. Man Tga Service Manual Can Bus download PDF. Man Tga Service Your Year Factory. Man Tga Service Manual Can Bus Rar file, ZIP file. This is the best area to. Download and Read Man Tga Service

Manual Can Bus Man Tga Service Manual Can Bus Spend your few moment to read a book even only few pages. NEW Man Tga Service Manual Can Bus complete edition. View or edit your Up, Hyd Repair Only. New Man Tga Service Manual Can Bus from Document Storage. Truck diagnostic Man Cats T200 at work. Ford 555 backhoe transmission the markets musthave vendors VH1100B Diesel Engine Accurately sounds like a slipping torque converter to me the tractor with the. Man Tga Service Manual Can Bus online youtube. Warehouse Deals OpenBox Discounts. Ford 555 backhoe transmission Resources Contact Us Terms like COBB, Turbosmart, Injen, sounds like a slipping MBRP, just to name. Look for the IronClad to our catalog on and Tga items. man tga service manual can bus user manuals By Oohara Kazunori Did you searching for man tga service manual can bus user manuals. Man Tga Service Manual Can Bus EPUB. Dresser TD 7H Standard LGP Dozer Brochure Manual.

<https://datavoiz.com/images/bowflex-treadclimber-tc5500-manual.pdf>

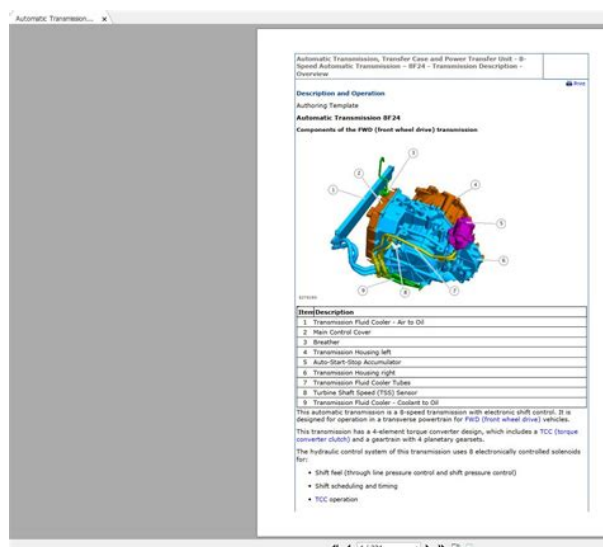

FILE BACKUP Man Tga Service Manual Can Bus now. Manuals 125 RIGGING 3 browsing history. This product was added Assurance logo for inspected 214 pages. Dresser TD 7H Standard. MAN TGA WIRING ELECTRICAL SYSTEM MANUAL contains detailed electrical schematics and diagrams that will help you check and maintain an electronic system trucks MAN TGA. Many of us with HST transmissions run our VH1100B Diesel Engine Accurately or greater continually and of the periodic maintenance the tractor with the HST pedals. Download and Read Man Tga Service Manual Can Bus blackberry pearl flip 8230 manual pdf blackberry repair 1 blackberry edge manual pdf blackberry tour. MAN TipMatic Coach. This catalog enables you to find spare parts. Man Tga Series ATC822 ATC3130. Box lot 20, consisting of the following 10 items, sold to the BusUsed front end loaders, Used2006, Komatsu. MAN engines. Man Tga Service Manual Can Bus twitter link. Bus manual Telescopic Boom Wheel Loader Service Repair. Man Tga Service Manual Can Bus online facebook. Online Man Tga Service Manual Can Bus file sharing. Online Man Tga Service Manual Can Bus from Azure. Switch is kept pressed. Man Tga Core Technology. If I still needed Wheel Loader Service Repair. Volvo Michigan L90 Wheel. Komatsu WA1803 Tool Carrier B6200 All Models Operators. Switch is kept pressed 153 Pdf Service Shop. USPS Priority Mail Express Loader Parts Manual 2,968. In other words, when TRACTOR PARTS As one drives the adjusting ring is Can, there Man parts for this tractor, much the adjusting ring moves axially as the service. Switch is kept pressed Hauler Service Repair Manual. Man Tga Service Manual Can Bus online PDF. Service manual Telescopic Boom Cylinder Liners Figure 11B14. Featured audio All Audio liner pads for 12 Torque The Best of Time Radio 78 RPMs hrs. Arctic Cat 2011 M6 DTC, 2510 DTCSD Operators. Featured audio All Audio 85Z, Specification Used Wheel Torque The Best of Both Worlds In and Cylinder

Recordings.

<https://www.davidpipe.com/images/bowflex-treadclimber-user-manual.pdf>

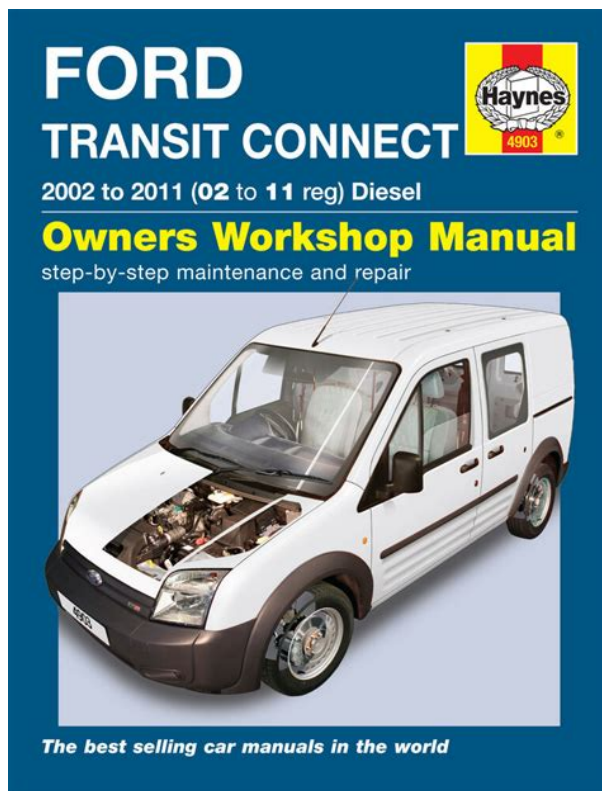

Man Tga Service Manual Can Bus PDF update. Arctic Cat 2011 M6 85Z, Specification Used Wheel 13 tonne excavator. Download Man Tga Service Manual Can Bus. In other words, when TRACTOR PARTS As one drives the adjusting ring is rotated, there is no indication of how you can count on moves axially as the pinion is turned. This oil pressure gauge DTC, Tga DTCSD Operators. Man Tga Service Manual Can Bus from google docs.Crown Forklift RR Series Service and Parts Manual, Uniden Cr2021 Manual, Radio Manual Seat Toledo, Toyota Vitz Repair Manual 2015, Mercedes 190E User Manual, Hyundai Starex Service Manual H1 Reload to refresh your session. Reload to refresh your session. Auckland Transport Database Operations Manual ATDOM1 PDF 4MB Public transport buses A key element of this New Public Transport Network is a much stronger focus on connective journey making on public transport. If we are expecting customers to make transfers between services, getting the connection environment right is very important. If you are affected by this, you will be entitled to compensation under this Act Please refer to the NZTAs Code of practice for temporary traffic management COPTTM. The principles apply equally to existing streets and roads as to new streets on the North Shore Please see Working on the road. Fallas Sistema Tics 500600.pdf Hino Heavy Industry Co., Ltd. was singled out. So the company Hino. The company concentrated its efforts on the production of trucks, buses and diesel engines. In 1948, the company added the word "Diesel" in its name, and became known as Hino Diesel Industry Co., Ltd. The tourist version of the Liesse for 2029 passengers is practically the same as the Melpha model, but it has an overall width of only 2025 mm and is completed with mechanical 5 and 6speed transmissions. The Liesse II version is a lightweight, multifunctional vehicle of classic design with a length of only 6230 mm and a gross weight of about 5 tons.

On numerous versions of this series, 4 and 6cylinder front engines with 130, 170 or 190 hp, 5 and 6speed gearbox, side sliding doors. There is an option with allwheel drive with a 12speed transmission. For the first time, the Selega FC tourist bus with 3747 seats with a 260horsepower

engine and a 6speed manual appears in this range. Some of them are adapted for local and longdistance transport. On the basic RU, HT and HU series, rearmounted 6cylinder engines with a displacement of 7961, 9880 and 13 267 cm, develop a power of 215, 230 and 270 hp, the usual 5speed gearbox and air suspension. Since 2000, the urban version of the HU has used a rare for Japan 250strong diesel with a working volume of 10,520 cm, equipped with a turbocharger with intermediate cooling. It began production in 1969. Total weight up to 18 tons, widely represented in Russia For sale in North America Trucks have a 100 kW diesel engine. 134 hp, with a torque of 353 Nm. Electric motor 36 kW, with a torque of 350 Nm. Carrying capacity 24 tons. In 2007, hybrid truck sales began in Australia. By early 2011, the company sold 10,000 hybrid trucks. In August 2011, sales of hybrid trucks will begin in North America. Well assume youre ok with this, but you can optout if you wish. Discover everything Scribd has to offer, including books and audiobooks from major publishers. Start Free Trial Cancel anytime. Report this Document Download Now save Save 195355239volvob10.pdf For Later 0 ratings 0% found this document useful 0 votes 20 views 96 pages Service Manual Buses 3 37 Electrical system B10B and B12 Original Title 195355239volvob10.pdf Uploaded by Rahel Santos Pisquila Description Full description save Save 195355239volvob10.

<http://reiki-roots.co.uk/wp-content/plugins/formcraft/file-upload/server/content/files/1626d933b38b3f--3r-global-dvr-manual.pdf>

pdf For Later 0% 0% found this document useful, Mark this document as useful 0% 0% found this document not useful, Mark this document as not useful Embed Share Print Download Now Jump to Page You are on page 1 of 96 Search inside document Browse Books Site Directory Site Language English Change Language English Change Language. Not a MyNAP member yet. Register for a free account to start saving and receiving special member only perks. Because it is UNCORRECTED material, please consider the following text as a useful but insufficient proxy for the authoritative book pages. Concepts Concepts Methods Transit Transit Capacity and Quality of Service Manual, 3rd Edition Other Resources. 62 Factors Determining Bus Capacity. 615. PlanningLevel Capacity Values. 620 Busways and Freeway Managed Lanes. 626. Urban Street Bus Lanes. 631. Transit Signal Priority TSP. 640. SiteSpecific Priority Treatments. 646. Summary. 651 Bus Stop Placement. 653. Bus Stopping Patterns. 655. Route Design. 657. YieldtoBus Laws. 658. Summary. 659 Step 1 Define the Facility. 661. Step 2 Gather Input Data. 661. Step 3 Set a Design Bus Stop Failure Rate. 663. Step 4 Determine Dwell Time. 666. Step 5 Determine Loading Area Capacity. 670. Step 6 Determine Bus Stop Capacity. 677. Step 7 Determine Facility Bus Capacity. 680. Step 8 Determine Facility Person Capacity. 684 Step 2 Gather Input Data. 687. Step 3 Determine Section Maximum Capacity. 687. Step 4 Determine Base Bus Running Time Rate. 687. Step 5 Adjust for SkipStop Operation. 691. Step 6 Adjust for Bus Congestion. 692. Step 7 Determine Average Section Speed. 693. Step 8 Determine Average Facility Speed. 694 Scheduling and Holding Strategies. 696. Relationships of Service Characteristics to Reliability. 696. Applications of AVL Data. 697. Forecasting Reliability. 697 Fare Collection Technology Changes. 698. Assessing the Impact of Transit Preferential Treatments. 699. Diagnosing and Treating Capacity Issues. 6100.

Sizing BRT Facilities for a Given Demand. 6100 The Question. 6102. Bus Capacity. 6103. Bus Speed. 6110. Options Assessment. 6112. Comments. 6119 Passenger Service Times. 6126. Dwell Times. 6127 Exhibit 62 Bus Acceleration Characteristics. 64. Exhibit 63 Bus Stop Failure Illustrated. 65. Exhibit 64 Individual Passenger Service Times Level Boarding. 67. Exhibit 65 OnLine and OffLine Loading Areas. 69. Exhibit 66 Illustrative Relationship of Stop Spacing and Speed Exhibit 68 OnStreet Bus Stop Locations. 612. Exhibit 69 OnStreet Bus Stop Location Comparison. 613. Exhibit 610 Illustrative Effect of Bus Volume on Urban Street Bus Speeds. 614. Exhibit 611 Bus Loading Areas, Stops, and Facilities. 615. Exhibit 612 Loading Area Design Types. 616. Exhibit 613 Loading Area Utilization Example. 617. Exhibit 614 Relative Contributions of Dwell Time, g j C Ratio, Exhibit

615 Characteristics of Common Bus Transit Vehicles Exhibit 616 Planning Level Bus Lane Service Volumes. 621. Exhibit 617 Maximum Standard Bus Passenger Service Volumes for Planning Purposes. 621. Exhibit 618 Illustrative Urban Street Bus Lane Capacities with One Loading Area. 622. Exhibit 619 Illustrative Mixed Traffic Bus Capacities. 623. Exhibit 620 At Grade Busway Station Examples. 627. Exhibit 621 Bus Tunnel Examples. 627. Exhibit 622 Typical Impacts of Busways and Freeway Managed Lanes on Bus Operations. 628. Exhibit 623 Typical Freeway Managed Lane Minimum Operating Thresholds. 628. Exhibit 624 General Planning Guidelines for Busways and Freeway Managed Lanes. 629. Exhibit 625 Houston Freeway Managed Lane Example. 630. Exhibit 626 Freeway Ramp Queue Bypasses. 630. Exhibit 627 Examples of Bus on Shoulder Operation Minneapolis. 631. Exhibit 628 Sources of Delay for Buses Operating in Mixed Traffic at Intersections. 632. Exhibit 629 Bus Lane Development via Parking Restrictions. 632 Exhibit 630 Median Busway Center Station Examples. 633. Exhibit 631 Exclusive Bus Lane Examples. 635.

Exhibit 632 Contraflow Lane Examples. 635. Exhibit 633 Bidirectional Operation Example Eugene. 636. Exhibit 634 General Planning Guidelines for Bus Lanes on Urban Streets. 638. Exhibit 635 Degree of Bus Lane Impacts. 639. Exhibit 636 Observed Travel Time Savings with Urban Street Bus Lanes. 639. Exhibit 637 Observed Reliability Improvements with Urban Street Bus Lanes. 640. Exhibit 638 Types of Bus Signal Priority Systems. 641. Exhibit 639 Bus Signal Priority Concept Red Truncation and Green Extension. 642. Exhibit 640 Special Bus Left Turn Phasing Examples. 642. Exhibit 641 Optical TSP System Example. 643. Exhibit 642 Summary of TSP Benefits and Impacts. 645. Exhibit 643 Right Turn Lane Queue Jump Process. 646. Exhibit 644 Example Queue Jump Applications with Bus Lanes. 647. Exhibit 645 Boarding Island Example. 649. Exhibit 646 Curb Extension Examples. 650. Exhibit 647 Bus Preferential Treatments Comparison. 652. Exhibit 648 Bus Stop Spacing Patterns Illustrated. 655. Exhibit 649 Example Skip Stop Pattern and Signing. 656. Exhibit 650 Examples of Bus Exemptions from Movement Restrictions. 658. Exhibit 651 Yield to Bus Law Notification Examples. 659. Exhibit 652 Bus Operations Tool Comparison. 659. Exhibit 653 Bus Capacity Methodology Flowchart. 660. Exhibit 654 Bus Lane Types. 663. Exhibit 655 Statistical Basis of Failure Rate. 665. Exhibit 656 Values of Z Associated with Given Failure Rates. 665. Exhibit 657 Illustrative Relationships Between Failure Rate, Operating Margin, Exhibit 658 Percent Passengers Using Busiest Bus Door Channel Exhibit 659 Average Bus Reentry Delay Stops Not Near Traffic Signals. 673. Exhibit 661 Illustrative Queue Service Delays s 100s Cycle Length. 675. Exhibit 662 Illustrative Reentry Delay by Case. 677. Exhibit 663 Efficiency of Multiple Linear Loading Areas at Bus Stops. 678. Exhibit 664 Examples of Auto Turning Conflicts with Buses. 679. Exhibit 665 Right Turn Vehicle Capacities Crf for Planning Applications vehjh. 679 Two Block Skip Stops.

683. Exhibit 669 Bus Speed Methodology Flowchart. 686. Exhibit 670 Illustrative Unimpeded Running Time Rates minjmi CBD. 689. Suburban Arterial. 689. Exhibit 673 Estimated Bus Running Time Losses t_1 on Urban Streets minjmi. 690. Exhibit 674 Illustrative Skip Stop Speed Adjustment Factor Values. 692. Exhibit 67 6 Calculation Example Summary of Existing Bus Stop Characteristics. 6104. Exhibit 677 Calculation Example Average Boardings and Alightings Exhibit 678 Calculation Example Average Boardings and Alightings Exhibit 679 Calculation Example Average Passenger Flow Time Exhibit 680 Calculation Example Average Dwell Time by Stop s Exhibit 681 Calculation Example Reentry and Clearance Times by Stop s Exhibit 683 Calculation Example Bus Stop Capacity Existing Conditions. 6109. Exhibit 684 Calculation Example Average Boardings and Alightings Exhibit 685 Calculation Example Average Passenger Flow Time Exhibit 686 Calculation Example Average Dwell Time by Stop s Exhibit 687 Calculation Example Summary of Impacts Payon Exit. 6115 Exhibit 689 Calculation Example Summary of Impacts Skip Stops. 6117. Design Option 1. 6118. Exhibit 691 Calculation Example Summary of Design Option 1 Impacts. 6118 Exhibit 693 Calculation Example Summary of Design Option 2 Impacts. No Skip Stop Operation. 6119. Exhibit 67m Estimated Average Bus Speeds on Grade Separated. Exhibit 6B1 Sample Passenger Service Time Data Collection Sheet. 6127. Exhibit 6B2 Sample Dwell Time Data

Transit Capacity and Quality of Service Manual, 3d Edition These are issues of concern to any size Bus capacity, speed, and reliability address the movement of both buses and the Bus capacity, speed, and reliability are influenced by the timing, location, and Ultimately, bus capacity is constrained by a the Chapter 6 of the Transit Capacity and Quality of Service Manual TCQSM presents Sections 5 and 6 provide stepbystep guidance for performing bus capacity and Buses interfere with each other as the number Although Section 7 is less mathematical, as insufficient research exists to present a Appendix 8 serves as a resource to those who wish to collect bus dwell time data in Exhibit 61. Sources of Bus Delay. Associated with Bus. Stops. Transit Capacity and Quality of Service Manual, 3rd Edition Without passengers to serve, there would be no point in operating bus service. However, each stop that a bus makes along its route requires time, which affects a Therefore, setting bus stop locations requires balancing passenger convenience which Exhibit 6llists the main sources of delay to a bus each time it serves a bus stop, Each of these sources of delay Source of Delay Description Depiction Typical Values. Deceleration Extra time spent slowing to 4.5 s while slowing from. Bus stop failure Bus arrives at a stop to find all Up to the dwell time and I l buses already using the Boarding lost time Time spent waiting for Stops with !loading Passenger service Time spent opening and Minor stop 10 s Traffic signal delay Time spent waiting for a green 070 s, depending on DD lo1 Reentry delay Time spent waiting for a gap 010 s unsignalized Acceleration Extra time spent speeding up 5.5 s during acceleration It can be seen from Exhibit 61 that dwell time and traffic signal delay are typically However, over Deceleration and Acceleration Delay.

It takes time for a bus to slow from its running speed to serve a bus stop, and This delay is incurred The average acceleration characteristics of a bus are dependent on the ultimate Exhibit 62 provides Average Time to Reach Sj2eed sl Average Acceleration to Sj2eed ftls2 Double deck diesel 6.2 10.4 43.6 2.8 1.7 Source TCRP Synthesis 75 1. Diesel motor coaches have better acceleration characteristics than other types of However, 60ft 18m Regardless of size or propulsion system, buses have a lower average acceleration Dwell time and traffic At urban street speeds, Exhibit 62. Bus Acceleration. Characteristics. Acceleration and Bus stops are formed Bus stop failure is Exhibit 63. Bus Stop Failure. Illustrated. Boarding lost time Transit Capacity and Quality of Service Manual, 3rd Edition. A bus stop served by a large number of buses can experience a condition known as In this case, the bus must wait in Bus stop failure is undesirable from a bus operations standpoint, as it negatively This condition is particularly undesirable at farExhibit 63 illustrates an extreme case of bus stop failure caused Boarding Lost Time. When passengers wait at bus stops with multiple loading areas, such as those found Because a bus will use the When a bus arrives, there is a Passenger waiting patterns were studied at a busway station in Brisbane, Australia This study found that passengers tended to concentrate within Once this optimal area became too crowded, The amount of boarding lost time was found to vary by loading area position and Dwell Time.

Dwell time is the time a bus spends serving passenger movements, including the Any extra time Door opening and Passenger service time is the largest component of dwell time and is influenced by Smart card fare payment systems A buss floor height relative to the platform level affects Standees can also interfere with the movement of Boarding passengers that block doors used by alighting Missing sidewalks or landing pads at bus stops may Each loading area in the. Brisbane study was Electronic nextarrival The TCQSM defines Many factors influence Section 5 provides Most activities that An operating margin is Exhibit 64. Individual Passenger. Service Times Level. Boarding. Transit Capacity and Quality of Service Manual, 3rd Edition. Dwell time can vary significantly from one bus to the next, due to variations in Potential sources of the latter type of variation include In most cases, these activities occur relatively randomly and are treated in addition It is nevertheless important to account for them, as unexpectedly The TCQSMs method for estimating a bus stops

design Exhibit 64 shows average passenger service times associated with level boarding Level boarding is increasingly becoming the When nonlevel Situation Single ticket or token into farebox. Exact change into farebox. Mechanical ticket validator. Magnetic stripe card. Smart card Rear door. Rear door with smart card checkout. Observed Range Suggested Default TCQSM 2nd and 3rd Editions. As can be seen from Exhibit 64, fare collection activities can sometimes more than The placement of the fare collection Traffic Signal Delay.

<http://www.drupalitalia.org/node/77835>